

## REMA Wirbelsicherheitslasthaken RSS (Güteklasse 10)

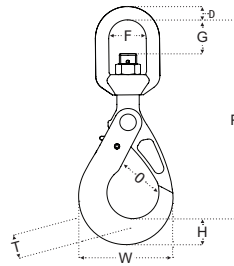

### Norm:

- EN 818, EN 1677, DIN 17115, DIN 5692



Typ	Tragfähigkeit (kg)	P (mm)	D (mm)	F (mm)	G (mm)	T (mm)	H (mm)	O (mm)	W (mm)	Gewicht (kg/st/m)	Artikel-Nr.
RSS-6	1.400	150	11.3	32.8	25.7	15.1	21.6	26.8	72.2	0.7	2646006
RSS-8	2.500	182	13.5	36.8	27.5	20.5	26.6	35.5	89.3	1.2	2646008
RSS-10	4.000	220	15.8	41	35.9	26.7	31	44.1	106.9	2	2646010
RSS-13	6.700	265	17.4	47.8	40	32.5	42.3	50.5	137.5	3.7	2646013
RSS-16	10.000	332	21.2	69.5	56	38.9	50	59.6	169	7.3	2646016

## REMA Wirbelsicherheitslasthaken RSBS (Güteklasse 10)



Dieser Wirbelsicherheitshaken ist unter Last drehbar.

### Norm:

- EN 818, EN 1677, DIN 17115, DIN 5692

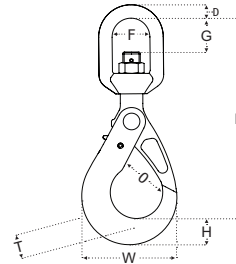

Typ	Tragfähigkeit (kg)	P (mm)	D (mm)	F (mm)	G (mm)	T (mm)	H (mm)	O (mm)	W (mm)	Gewicht (kg/st/m)	Artikel-Nr.
RSBS-6	1.400	195	14	37	32	16	21.6	26.8	72.2	0.8	2646106
RSBS-8	2.500	202	15.0	41	39	20	26.6	35.5	89.3	1.2	2646108
RSBS-10	4.000	244	17.5	48	48	26	27.5	44.1	106.9	2.2	2646110
RSBS-13	6.700	292	19.0	55	57	32.5	40	50.5	137.5	4.4	2646113
RSBS-16	10.000	346	26	62	62	38	50	59.6	169	7.5	2646116

## REMA Parallelhaken REG (Güteklasse 10)



### Norm:

- EN 818, EN 1677, DIN 17115, DIN 5692

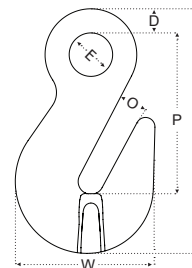

Typ	Tragfähigkeit (kg)	P (mm)	D (mm)	E (mm)	T (mm)	O (mm)	W (mm)	Gewicht (kg/st/m)	Artikel-Nr.
REG-6	1.400	45.3	8.3	14.2	73.2	7.5	42.7	0.2	2648006
REG-8	2.500	60.3	9.7	18.2	92.5	11.0	53.5	0.3	2648008
REG-10	4.000	82.7	13.1	22	128	13.2	73.5	0.7	2648010
REG-13	6.700	103.5	16.1	26.8	165	16.5	96.7	1.7	2648013
REG-16	10.000	118	19.6	35.9	182	19.5	113.2	3.0	2648016
REG-20	16.000	147	23	43.5	227	24	143	4.72	2648020